

**Panasonic**

**LED**

**LED  
LIGHTING  
CATALOGUE  
2023-2024**



# Panasonic

## Illumination that inspires the best in you

Panasonic Electric Works supports lighting the future.  
We offer optimum lighting solutions to the  
overseas market with a wide product range.



**Grand Indonesia**  
Indonesia

**Tokyu Plaza Ginza**  
Japan

**Tenggarong Bridge**  
Indonesia



**Tokyo Skytree**  
Japan



**Gelora Bung Karno Stadium**  
Indonesia

**Prag Castle**  
Czech Republic





PANASONIC  
LED STANDART LAMPS

/ 6



PANASONIC  
DIMMABLE LAMPS

/ 12



PANASONIC  
LED TUBE G13

/ 18



PANASONIC  
BT WIFI RGB LED LAMPS

/ 22



PANASONIC  
LED SPLASH PROOF

/ 28



PANASONIC  
LED FLOODLIGHT

/ 32



PANASONIC  
LED DOWNLIGHT

/ 36

PANASONIC  
LED TORCH LAMPS

/ 10



PANASONIC  
LED FILAMENT LAMPS

/ 14



PANASONIC  
REMOTE CONTROL RGB LED LAMP

/ 20



PANASONIC  
LED BACKLIT

/ 26



PANASONIC  
LED SPLASH PROOF SENSOR

/ 28



PANASONIC  
LED FLOODLIGHT SENSOR

/ 32





## Panasonic LED Standard Lamps

Panasonic illuminates your home with its products that combine high technology, superior performance, safety and design. The LED lamps series provides light temperatures up to 2700K, 3000K, 4000K, 6500K with warm white, cool white, neutral white options, every point of living spaces, from kitchens to study rooms, meets with ideal quality lighting.

E14, E27, GU10 type led lamps from power energy offers high energy efficacy up to 109lm/W while creating alight and homey spaces with clean and panoramic angle thanks to it cutting edge technology.

Enlightening the world  
with **Panasonic safe and efficient lighting**



## Excellent LED Standart Lamps within gorgeous classic appearance

### Product Features;

- Uniform light distribution with 200° beam angle.
- Made in Türkiye production.

### Areas of application;

- Domestic applications
- General illumination

## E27



200°



2700K/4000K/6500K



E27



15.000 Hour



Energy Class



IP 20



CRI



Class



Product Code	Product Description	Power (W)	Equivalent Power (W)	Operating Voltage (V)	Color Rendering Index (Ra)	Color Temperature	Luminous Flux (lm)	Efficiency Factor (lm/W)	Energy Class	Light Beam Angle	Size (B) (mm)	Diameter (E) (mm)	Quantity in Box
LDACH05LG3T7	PANASONIC LED E27 4,9W 470LM 2700K	4,9	40	220-240	≥80	2700K	470	96	F	200°	107	60	20
LDACH05WG3T7	PANASONIC LED E27 4,9W 515LM 4000K	4,9	43	220-240	≥80	4000K	515	105	F	200°	107	60	20
LDACH05DG3T7	PANASONIC LED E27 4,9W 515LM 6500K	4,9	43	220-240	≥80	6500K	515	105	F	200°	107	60	20
LDACH09LG3T7	PANASONIC LED E27 8,5W 806LM 2700K	8,5	60	220-240	≥80	2700K	806	95	F	200°	107	60	20
LDACH09WG3T7	PANASONIC LED E27 8,5W 860LM 4000K	8,5	63	220-240	≥80	4000K	860	101	F	200°	107	60	20
LDACH09DG3T7	PANASONIC LED E27 8,5W 860LM 6500K	8,5	63	220-240	≥80	6500K	860	101	F	200°	107	60	20
LDACH11LG3T7	PANASONIC LED E27 10,5W 1055LM 2700K	10,5	75	220-240	≥80	2700K	1.055	101	F	200°	111	60	20
LDACH11WG3T7	PANASONIC LED E27 10,5W 1055LM 4000K	10,5	75	220-240	≥80	4000K	1.055	101	F	200°	111	60	20
LDACH11DG3T7	PANASONIC LED E27 10,5W 1055LM 6500K	10,5	75	220-240	≥80	6500K	1.055	101	F	200°	111	60	20
LDACH14LG3T7	PANASONIC LED E27 14W 1521LM 2700K	14	100	220-240	≥80	2700K	1.521	109	F	200°	120	60	20
LDACH14WG3T7	PANASONIC LED E27 14W 1521LM 4000K	14	100	220-240	≥80	4000K	1.521	109	F	200°	120	60	20
LDACH14DG3T7	PANASONIC LED E27 14W 1521LM 6500K	14	100	220-240	≥80	6500K	1.521	109	F	200°	120	60	20



E14



240°



2700K/4000K/6500K



E14



15.000 Hour



Energy Class



IP 20



CRI



Class

Product Code	Product Description	Power (W)	Equivalent Power (W)	Operating Voltage (V)	Color Rendering Index (Ra)	Color Temperature	Luminous Flux (lm)	Efficiency Factor (lm/W)	Energy Class	Light Beam Angle	Size (B) (mm)	Diameter (E) (mm)	Quantity in Box
LDCCH05LG3T4	PANASONIC LED E14 4,9W 470LM 2700K	4.9	40	220-240	≥80	2700K	470	96	F	240°	100	37	20
LDCCH05WG3T4	PANASONIC LED E14 4,9W 470LM 4000K	4.9	40	220-240	≥80	4000K	470	96	F	240°	100	37	20
LDCCH05DG3T4	PANASONIC LED E14 4,9W 470LM 6500K	4.9	40	220-240	≥80	6500K	470	96	F	240°	100	37	20
LDCCH07LG3T4	PANASONIC LED E14 6,5W 640LM 2700K	6.5	50	220-240	≥80	2700K	640	99	F	240°	107	37	20
LDCCH07WG3T4	PANASONIC LED E14 6,5W 640LM 4000K	6.5	50	220-240	≥80	4000k	640	99	F	240°	107	37	20
LDCCH07DG3T4	PANASONIC LED E14 6,5W 640LM 6500K	6.5	50	220-240	≥80	6500K	640	99	F	240°	107	37	20



GU10



39°/60°



2700K/4000K/6500K



G10



15.000 Hour



Energy Class



IP 20



CRI



Class

Product Code	Product Description	Power (W)	Equivalent Power (W)	Operating Voltage (V)	Color Rendering Index (Ra)	Color Temperature	Luminous Flux (lm)	Efficiency Factor (lm/W)	Energy Class	Light Beam Angle	Size (B) (mm)	Diameter (E) (mm)	Quantity in Box
LDRCH04LN4T1	PANASONIC LED GU10 4W 310LM 2700K	4	45	220-240	≥80	2700K	310	78	F	39°	54	50	30
LDRCH04LN3T1	PANASONIC LED GU10 4W 310LM 3000K	4	45	220-240	≥80	3000K	310	78	F	39°	54	50	30
LDRCH04WN3T1	PANASONIC LED GU10 4W 345LM 4000K	4	50	220-240	≥80	4000K	345	86	F	39°	54	50	30
LDRCH04DN3T1	PANASONIC LED GU10 4W 345LM 6500K	4	50	220-240	≥80	6500K	345	86	F	39°	54	50	30
LDRCH06LN4T1	PANASONIC LED GU10 6W 420LM 2700K	6	60	220-240	≥80	2700K	420	70	G	39°	54	50	30
LDRCH06LN3T1	PANASONIC LED GU10 6W 420LM 3000K	6	60	220-240	≥80	3000K	420	70	G	39°	54	50	30
LDRCH06WN3T1	PANASONIC LED GU10 6W 440LM 4000K	6	62	220-240	≥80	4000K	440	73	F	39°	54	50	30
LDRCH06DN3T1	PANASONIC LED GU10 6W 440LM 6500K	6	62	220-240	≥80	6500K	440	73	F	39°	54	50	30
LDRCH04LW4T1	PANASONIC LED GU10 4W 310LM 2700K 60°	4	45	220-240	≥80	2700K	310	78	F	60°	54	50	30
LDRCH04LW3T1	PANASONIC LED GU10 4W 310LM 3000K 60°	4	45	220-240	≥80	3000K	310	78	F	60°	54	50	30
LDRCH04WW3T1	PANASONIC LED GU10 4W 345LM 4000K 60°	4	50	220-240	≥80	4000K	345	86	F	60°	54	50	30
LDRCH04DW3T1	PANASONIC LED GU10 4W 345LM 6500K 60°	4	50	220-240	≥80	6500K	345	86	F	60°	54	50	30
LDRCH06LW4T1	PANASONIC LED GU10 6W 420LM 2700K 60°	6	60	220-240	≥80	2700K	420	70	G	60°	54	50	30
LDRCH06LW3T1	PANASONIC LED GU10 6W 430LM 3000K 60°	6	61	220-240	≥80	3000K	430	70	G	60°	54	50	30
LDRCH06WW3T1	PANASONIC LED GU10 6W 440LM 4000K 60°	6	62	220-240	≥80	4000K	440	73	F	60°	54	50	30
LDRCH06DW3T1	PANASONIC LED GU10 6W 440LM 6500K 60°	6	62	220-240	≥80	6500K	440	73	F	60°	54	50	30

**Panasonic**





Affordable price, high performance, a true warrior.

While Torch lamps provide energy efficiency up to 131lm/W, they can easily be inserted instead of standard lamps thanks to classical E27 socket and in this way; they allow easy installation in retail and personal applications. Torch lamps offer more homogeneous lighting with four different power options of 18W, 23W, 35W, 45W and color temperatures of 3000K, 4000K, 6500K.

### Product Features:

- 18W-23W-35W-45W power options
- Long life up to 15000 hour with excellent luminosity
- 3000K/4000K/6000K color temperature options



E27



200°



3000K/4000K/6500K



E27



15.000 Hour

E/F

Energy Class



IP 20



CRI 80+



CLASS II

Product Code	Product Description	Power (W)	Equivalent Power (W)	Operating Voltage (V)	Color Rendering Index (Ra)	Color Temperature	Luminous Flux (lm)	Efficiency Factor (lm/W)	Energy Class	Light Beam Angle	Size (B) (mm)	Diameter (E) (mm)	Quantity in Box
LDTCH18LG1E7	PANASONIC E27 TORCH LED LAMP 18W 1860LM 3000K	18	100	220-240	≥80	3000K	1.860	103	F	200°	142	80	30
LDTCH18WG1E7	PANASONIC E27 TORCH LED LAMP 18W 1980LM 4000K	18	100	220-240	≥80	4000K	1.980	110	E	200°	142	80	30
LDTCH18DG1E7	PANASONIC E27 TORCH LED LAMP 18W 2040LM 6500K	18	100	220-240	≥80	6500K	2.040	113	E	200°	142	80	30
LDTCH23LG1E7	PANASONIC E27 TORCH LED LAMP 23W 2430LM 3000K	23	100	220-240	≥80	3000K	2.430	106	F	200°	166	100	20
LDTCH23WG1E7	PANASONIC E27 TORCH LED LAMP 23W 2600LM 4000K	23	100	220-240	≥80	4000K	2.600	113	E	200°	166	100	20
LDTCH23DG1E7	PANASONIC E27 TORCH LED LAMP 23W 2650LM 6500K	23	100	220-240	≥80	6500K	2.650	115	E	200°	166	100	20
LDTCH35LG1E7	PANASONIC E27 TORCH LED LAMP 35W 4140LM 3000K	35	150	220-240	≥80	3000K	4.140	118	E	200°	202	118	20
LDTCH35WG1E7	PANASONIC E27 TORCH LED LAMP 35W 4570LM 4000K	35	150	220-240	≥80	4000K	4.570	131	E	200°	202	118	20
LDTCH35DG1E7	PANASONIC E27 TORCH LED LAMP 35W 4190LM 6500K	35	150	220-240	≥80	6500K	4.190	120	E	200°	202	118	20
LDTCH45LG1E7	PANASONIC E27 TORCH LED LAMP 45W 5250LM 3000K	45	200	220-240	≥80	3000K	5.250	117	E	200°	228	138	8
LDTCH45WG1E7	PANASONIC E27 TORCH LED LAMP 45W 5330LM 4000K	45	200	220-240	≥80	4000K	5.330	119	E	200°	228	138	8
LDTCH45DG1E7	PANASONIC E27 TORCH LED LAMP 45W 5370LM 6500K	45	200	220-240	≥80	6500K	5.370	119	E	200°	228	138	8

Everything is in your control with the energy saving, LED Dimmable Lamps that allow you to adjust the lighting level.

### Product Features:

- Light brightness control
- 2700K/4000K/6500K colour temperature options
- Compatible with Dim Switches\* and KNX Automation Switches
- Complete solution as Panasonic LED Lamp +Dim Switch

\* Compatible with RC 400W Dimmers and Universal Dimmers.

## E27

 200°
  2700K/4000K/6500K
  E27
  Dimmable
  15.000 Hour
  Energy Class F
  IP 20
  CRI 80+
  Class



Product Code	Product Description	Power (W)	Equivalent Power (W)	Operating Voltage (V)	Color Rendering Index (Ra)	Color Temperature	Luminous Flux (lm)	Efficiency Factor (lm/W)	Energy Class	Light Beam Angle	Size (B) (mm)	Diameter (E) (mm)	Quantity in Box
LDACH09LGDR7	PANASONIC E27 LED DIM LAMP 8.5W 806LM 2700K	8,5	60	220-240	≥80	2700K	806	95	F	200°	111	60	100
LDACH09WGDR7	PANASONIC E27 LED DIM LAMP 8.5W 806LM 4000K	8,5	60	220-240	≥80	4000K	806	95	F	200°	111	60	100
LDACH09DGDR7	PANASONIC E27 LED DIM LAMP 8.5W 806LM 6500K	8,5	60	220-240	≥80	6500K	806	95	F	200°	111	60	100
LDACH11LGDR7	PANASONIC E27 LED DIM LAMP 10.5W 1055LM 2700K	10,5	75	220-240	≥80	2700K	1.055	100	F	200°	120	60	100
LDACH11WGDR7	PANASONIC E27 LED DIM LAMP 10.5W 1055LM 4000K	10,5	75	220-240	≥80	4000K	1.055	100	F	200°	120	60	100
LDACH11DGDR7	PANASONIC E27 LED DIM LAMP 10.5W 1055LM 6500K	10,5	75	220-240	≥80	6500K	1.055	100	F	200°	120	60	100



## E14



240°



2700K/4000K/6500K



E14



Dimmable



15.000 Hour



Energy Class



IP 20



CRI



Class

Product Code	Product Description	Power (W)	Equivalent Power (W)	Operating Voltage (V)	Color Rendering Index (Ra)	Color Temperature	Luminous Flux (lm)	Efficiency Factor (lm/W)	Energy Class	Light Beam Angle	Size (B) (mm)	Diameter (E) (mm)	Quantity in Box
LDCCH05LGDR4	PANASONIC E14 LED DIM LAMP 4,7W 470LM 2700K	4,7	40	220-240	≥80	2700K	470	100	F	240°	107	37	100
LDCCH05WGDR4	PANASONIC E14 LED DIM LAMP 4,7W 470LM 4000K	4,7	40	220-240	≥80	4000K	470	100	F	240°	107	37	100
LDCCH05DGDR4	PANASONIC E14 LED DIM LAMP 4,7W 470LM 6500K	4,7	40	220-240	≥80	6500K	470	100	F	240°	107	37	100

## GU10



39°

2700K/3000K  
4000K/6500K

GU10



Dimmable



15.000 Hour



Energy Class



IP 20



CRI



Class

Product Code	Product Description	Power (W)	Equivalent Power (W)	Operating Voltage (V)	Color Rendering Index (Ra)	Color Temperature	Luminous Flux (lm)	Efficiency Factor (lm/W)	Energy Class	Light Beam Angle	Size (B) (mm)	Diameter (E) (mm)	Quantity in Box
LDRCH04LWDR1	PANASONIC GU10 LED DIM LAMP 4W 310LM 2700K	4	45	220-240	≥80	2700K	310	78	F	39°	54	50	150
LDRCH04WWDR1	PANASONIC GU10 LED DIM LAMP 4W 310LM 3000K	4	45	220-240	≥80	3000K	310	78	F	39°	54	50	150
LDRCH04WWDR2	PANASONIC GU10 LED DIM LAMP 4W 310LM 4000K	4	45	220-240	≥80	4000K	310	78	F	39°	54	50	150
LDRCH04DWDR1	PANASONIC GU10 LED DIM LAMP 4W 310LM 6500K	4	45	220-240	≥80	6500K	310	78	F	39°	54	50	150

## Panasonic LED Filament Lamps

*The derivation of light.*

Panasonic LED Filament Lamps with the options of clear and gold glass colors, offers a great retrofit solution. Have dramatic reduction in energy usage up to 118 lm/W and fascinating evolution in the quality of light. Gold filament lamp with its color temperature of 2000 Kelvin and clear filament lamp with its color temperature of 2700 Kelvin creates an ultra-warm, comfortable, decorative atmosphere.

Their retro style that match with conventional lamp design brings desired style into reality with its classic, candle, retro and globe models. Has a long life of up to 15.000 hours, and even light distribution with 360° illumination, creates ideal light for retail and commercial applications.





LED



## E27



360°



2000K/2700K



E27



15.000 Hour

**E/F**

Energy Class



IP 20



80+

CRI



CLASS II

Class



Product Code	Product Description	Power (W)	Equivalent Power (W)	Operating Voltage (V)	Color Rendering Index (Ra)	Color Temperature	Luminous Flux (lm)	Efficiency Factor (lm/W)	Energy Class	Light Beam Angle	Size (B) (mm)	Diameter (E) (mm)	Quantity in Box
LDTCH45DG1E7	PANASONIC E27 FIL LAMP 4W 470LM 2700K CLEAR	4	40	220-240	≥80	2700K	470	118	E	360°	105	60	10
LDACH04LH1EA	PANASONIC E27 FIL LAMP 4W 360LM 2000K GOLD	4	40	220-240	≥80	2000K	360	90	F	360°	105	60	10
LDACH07LH1EC	PANASONIC E27 FIL LAMP 7W 806LM 2700K CLEAR	7	60	220-240	≥80	2700K	806	115	E	360°	105	60	10
LDACH07LH1EA	PANASONIC E27 FIL LAMP 7W 630LM 2000K GOLD	7	60	220-240	≥80	2000K	630	90	F	360°	105	60	10

## ST64



360°



2000K/2700K



E27



15.000 Hour

**E/F**

Energy Class



IP 20



80+

CRI



CLASS II

Class



Product Code	Product Description	Power (W)	Equivalent Power (W)	Operating Voltage (V)	Color Rendering Index (Ra)	Color Temperature	Luminous Flux (lm)	Efficiency Factor (lm/W)	Energy Class	Light Beam Angle	Size (B) (mm)	Diameter (E) (mm)	Quantity in Box
LDSCH04LH1EC	PANASONIC E27 FIL ST64 LAMP 4W 470LM 2700K CLEAR	4	40	220-240	≥80	2700K	470	118	E	360°	140	64	10
LDSCH04LH1EA	PANASONIC E27 FIL ST64 LAMP 4W 360LM 2000K GOLD	4	40	220-240	≥80	2000K	360	90	F	360°	140	64	10
LDSCH07LH1EC	PANASONIC E27 FIL ST64 LAMP 7W 806LM 2700K CLEAR	7	60	220-240	≥80	2700K	806	115	E	360°	140	64	10
LDSCH07LH1EA	PANASONIC E27 FIL ST64 LAMP 7W 630LM 2000K GOLD	7	60	220-240	≥80	2000K	630	90	F	360°	140	64	10

## E14



360°



2000K/2700K



E14



15.000 Hour

E/F/G

Energy Class



IP 20



80+

CRI



CLASS II

Class

Product Code	Product Description	Power (W)	Equivalent Power (W)	Operating Voltage (V)	Color Rendering Index (Ra)	Color Temperature	Luminous Flux (lm)	Efficiency Factor (lm/W)	Energy Class	Light Beam Angle	Size (B) (mm)	Diameter (E) (mm)	Quantity in Box
LDCCH02LH1EC	PANASONIC E14 FIL LAMP 2W 200LM 2700K CLEAR	2,2	25	220-240	≥80	2700K	200	91	F	360°	97	35	10
LDCCH02LH1EA	PANASONIC E14 FIL LAMP 2W 150LM 2000K GOLD	2,2	25	220-240	≥80	2000K	150	68	G	360°	97	35	10
LDCCH04LH1EC	PANASONIC E14 FIL LAMP 4W 470LM 2700K CLEAR	4	40	220-240	≥80	2700K	470	118	E	360°	97	35	10
LDCCH04LH1EA	PANASONIC E14 FIL LAMP 4W 360LM 2000K GOLD	4	40	220-240	≥80	2000K	360	90	F	360°	97	35	10



## G95 / G125



360°



2000K/2700K



E27



15.000 Hour

E/F

Energy Class



IP 20



80+

CRI



CLASS II

Class

Product Code	Product Description	Power (W)	Equivalent Power (W)	Operating Voltage (V)	Color Rendering Index (Ra)	Color Temperature	Luminous Flux (lm)	Efficiency Factor (lm/W)	Energy Class	Light Beam Angle	Size (B) (mm)	Diameter (E) (mm)	Quantity in Box
LDGCH07LH2EC	PANASONIC E27 FIL G95 LAMP 7W 806LM 2700K CLEAR	7	60	220-240	≥80	2700K	806	115	E	360°	138	95	10
LDGCH07LH2EA	PANASONIC E27 FIL G95 LAMP 7W 630LM 2000K GOLD	7	60	220-240	≥80	2000K	630	90	F	360°	138	95	10
LDGCH07LH1EC	PANASONIC E27 FIL G125 LAMP 7W 806LM 2700K CLEAR	7	60	220-240	≥80	2700K	806	115	E	360°	173	125	10
LDGCH07LH1EA	PANASONIC E27 FIL G125 LAMP 7W 630LM 2000K GOLD	7	60	220-240	≥80	2000K	630	90	F	360°	173	125	10



## Panasonic LED Tube G13

*Modern lighting that facilitates the transition to new technology.*

Panasonic LED Tube facilitates the transition from traditional technology to modern LED lighting products with its plug-and-play concept. It offers an environmentally friendly lighting solution with its long lifespan and energy-saving benefits.



LED TUBE G13

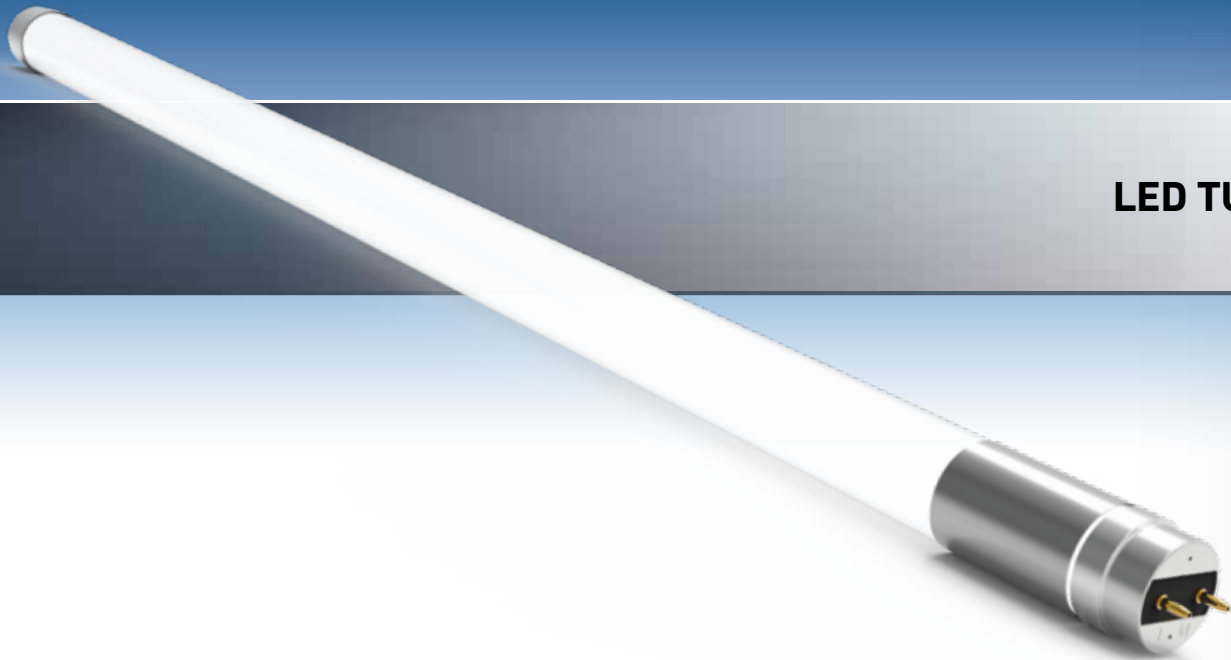

Product Code	Product Description	Power (W)	Operating Voltage (V)	Color Rendering Index (Ra)	Color Temperature	Luminous Flux (lm)	Efficiency Factor (lm/W)	Energy Class	Product Size (mm)	Quantity in Box
BPT100S830TA	PANASONIC LED TUBE T8 9W 1000LM 60CM G13 3000K	9	220-240	≥80	3000K	1000	111	E	600*Ø25,4	25
BPT100S840TA	PANASONIC LED TUBE T8 9W 1000LM 60CM G13 4000K	9	220-240	≥80	4000K	1000	111	E	600*Ø25,4	25
BPT100S865TA	PANASONIC LED TUBE T8 9W 1000LM 60CM G13 6500K	9	220-240	≥80	6500K	1000	111	E	600*Ø25,4	25
BPT200M830TA	PANASONIC LED TUBE T8 18W 2000LM 120CM G13 3000K	18	220-240	≥80	3000K	2000	111	E	1200*Ø25,4	25
BPT200M840TA	PANASONIC LED TUBE T8 18W 2000LM 120CM G13 4000K	18	220-240	≥80	4000K	2000	111	E	1200*Ø25,4	25
BPT200M865TA	PANASONIC LED TUBE T8 18W 2000LM 120CM G13 6500K	18	220-240	≥80	6500K	2000	111	E	1200*Ø25,4	25

Installation:

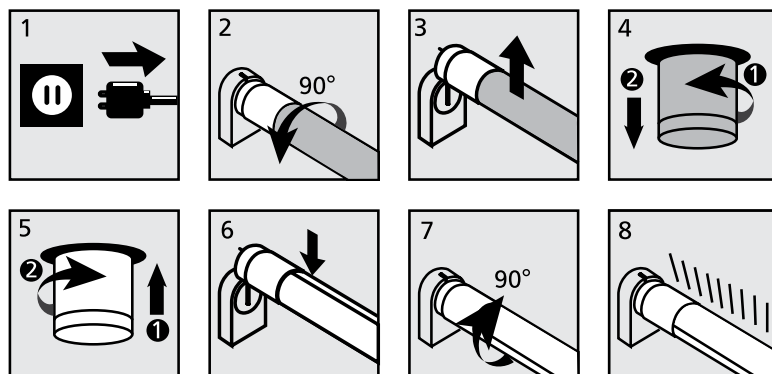

Compatible both for fixtures with magnetic balast and 220V products.

# Panasonic

## Panasonic Remote Control RGB LED Lamp

*Very colorful, very stylish.*

The Panasonic Remote Control Lamp with color-changing, dimmable RGB-2700K light adds color and elegance to any environment.







## REMOTE CONTROL LED LAMP

Multi-colored,  
extremely stylish.

Panasonic Remote Control RGB Lamp with dimmable RGB-2700K light adds color and elegance to every environment..

### Product Features:

- 2700K+RGB color options
- Multi-colored and stylish
- Easy remote control
- 4 lighting modes ; Flash, Strobe, Fade and Smooth



200°



2700K



E27



15.000 Hour



Controlled



Energy Class



IP 20



CRI



Class

Product Code	Product Description	Power (W)	Equivalent Power (W)	Operating Voltage (V)	Color Rendering Index (Ra)	Color Temperature	Luminous Flux (lm)	Efficiency Factor (lm/W)	Energy Class	Light Beam Angle	Size (B) (mm)	Diameter (E) (mm)	Quantity in Box
LDACH09LGRR7	PANASONIC E27 LED SMART REMOTE CONTROLLED LAMP 9W RGB	9	60	220-240	≥80	RGB+2700K	806	90	F	200°	114	60	100

## Panasonic Smart BT Wi-Fi RGB LED Lamp Series

*Very colorful, very smart.*

With the application-controlled dimmable RGB+White light from the Panasonic Smart Lamp Series, you can swiftly and effortlessly bring color and enjoyment to any environment.

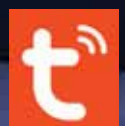





Very colorful,  
very smart.















Panasonic Smart Lamp Series with dimmable RGB+White light add color and fun to every space with minimum effort thanks to its controllability over the application.

### Product Features:

- Connection via Wi-Fi and Bluetooth
- Compatibility with Circadian rhythm
- Voice Assistant programmable feature
- Control via Tuya, Amazon Alexa, Google Assistant
- 2700K~6500K + RGB



## E27

 200°	 2700K/6500K	 E27	 15.000 Hour	 Energy Class	 IP 20	 CRI	 Class
 Control via App.	 Dimmable via App.	 BT - Wi-Fi Control	 Voice Assistant	 Scheduling	 Circadian Rhythm		



Product Code	Product Description	Power (W)	Equivalent Power (W)	Operating Voltage (V)	Color Rendering Index (Ra)	Color Temperature	Luminous Flux (lm)	Efficiency Factor (lm/W)	Energy Class	Light Beam Angle	Size (B) (mm)	Diameter (E) (mm)	Quantity in Box
LDACH09AGSR7	PANASONIC LED SMART BT WIFI RGB E27 LAMBA 9W	8,5	60	220-240	≥80	RGB+2700K-6500K	800	90	F	200°	113	60	60

E14



200°



2700K/6500K



E14



15.000 Hour



Energy Class



IP 20



CRI



Class



Control via App.



Dimmable via App.



BT - Wi-Fi Control



Voice Assistant



Scheduling



Circadian Rhythm

Product Code	Product Description	Power (W)	Equivalent Power (W)	Operating Voltage (V)	Color Rendering Index (Ra)	Color Temperature	Luminous Flux (lm)	Efficiency Factor (lm/W)	Energy Class	Light Beam Angle	Size (B) (mm)	Diameter (E) (mm)	Quantity in Box
LDCCH05AGSR4	PANASONIC LED SMART BT WIFI RGB E14 LAMBA 4,9W	4,9	40	220-240	≥80	RGB+2700K-6500K	470	95	F	200°	107	37,5	60

GU10



40°



2700K/6500K



GU10



15.000 Hour



Energy Class



IP 20



CRI



Class



Control via App.



Dimmable via App.



BT - Wi-Fi Control



Voice Assistant



Scheduling



Circadian Rhythm

Product Code	Product Description	Power (W)	Equivalent Power (W)	Operating Voltage (V)	Color Rendering Index (Ra)	Color Temperature	Luminous Flux (lm)	Efficiency Factor (lm/W)	Energy Class	Light Beam Angle	Size (B) (mm)	Diameter (E) (mm)	Quantity in Box
LDRCH05AWSR1	PANASONIC LED SMART BT WIFI RGB GU10 LAMBA 4,9W	4,9	51	220-240	≥80	RGB+2700K-6500K	350	84	G	40°	54	50	60

**Panasonic**

# Panasonic LED Backlit Panel

*Precise balance of light.*







## LED BACKLIT



It delivers a high efficacy value with 30.000h life time. Flush mounted directly against the ceiling, suitable undoubtedly for office, retail, education and hospitality with its different size of (dimensions) 600x600mm and 300x1200mm body options and accessories are available for different ceiling and installation types.

### Product Features:

- High efficacy.
- 2 different size options.
- 2 different color options.

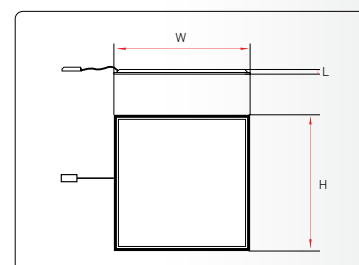

Product Code	Product Description	Power (W)	Input Voltage (V)	Ra	CCT	Lumen (lm)	Energy Class	Product Size (mm)	Quantity in Box
NFV60141WE1M	PANASONIC 60X60 BACKLIT 40W 4400LM 840	40	220-240	≥80	4000K	4400	F	595*595*35	6
NFV60143WE1M	PANASONIC 60X60 BACKLIT 40W 4400LM 865	40	220-240	≥80	6500K	4400	F	595*595*35	6
NFV60145WE1M	PANASONIC 30X120 BACKLIT 40W 4400LM 840	40	220-240	≥80	4000K	4400	F	295*1195*35	6
NFV60147WE1M	PANASONIC 30X120 BACKLIT 40W 4400LM 865	40	220-240	≥80	6500K	4400	F	295*1195*35	6

### Accessories

Product No	Description	Outer Carton Qty (pcs)	Corresponding Backlit Panel
NFV90015WE1M	PANASONIC LED BACKLIT PANEL PLASTER BOARD CEILING MOUNTING KIT	100pcs	40W: NFV60141WE1M, NFV60143WE1M, NFV60145WE1M, NFV60147WE1M
NFV90016WE1M	PANASONIC LED BACKLIT PANEL PENDANT MOUNTING KIT	100pcs	40W: NFV60141WE1M, NFV60143WE1M, NFV60145WE1M, NFV60147WE1M
NFV90017WE1M	PANASONIC LED BACKLIT PANEL SURFACE MOUNTING FRAME (60x60)	20pcs	40W 2x2: NFV60141WE1M, NFV60143WE1M
NFV90018WE1M	PANASONIC LED BACKLIT PANEL SURFACE MOUNTING FRAME (30x120)	20pcs	40W 1x4: NFV60145WE1M, NFV60147WE1M

## Panasonic LED Splash Proof Panasonic LED Splash Proof Sensor

*Professional lighting under harsh conditions.*

Panasonic LED Splash Proof is designed in an aesthetic and natural form to be suitable for industrial, commercial and residential environments. It is a good alternative to traditional fluorescent type luminaires due to its energy efficiency, superior life span with 25000hr and low maintenance cost. With Panasonic LED Splash Proof Sensor; security is no longer an issue due to its motion-sensitive sensors. Because of its durability to adverse situations, it offers you comfortable environments by supplying constant and uninterrupted light.







## LED SPLASH PROOF



4000K/6500K

0.9

25.000 Hour

Energy Class

CRI

Class

It can be integrated with the applications that need high luminous intensity. Panasonic Splash Proof reflects Panasonic quality with homogenous light distribution not straining eyes thanks to poly-carbon optic diffuser.

While it provides a wider area illumination by reducing eye dazzling with 36 Watt and 45 Watt power options and 4000K, 6500K color temperatures, it offers high energy efficiency up to 111lm/W. Panasonic Splash Proof is easily installed with 120 cm and 150 cm compact dimensions and always preferred in the projects with its IP65 protection class in indoor and outdoor environment where water and moisture widely exist.

### Product Features:

- 2 different lumen package and length option
- 4000K/6500K color options
- Easy Installation

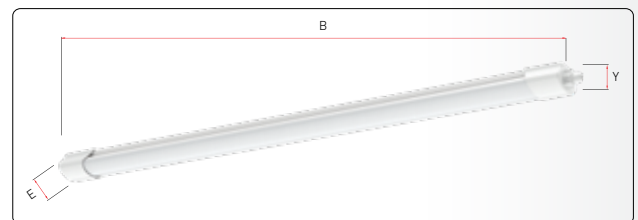

Product Code	Product Description	Power (W)	IP	Operating Voltage (V)	Color Rendering Index (Ra)	Color Temperature	Luminous Flux (lm)	Efficiency Factor (lm/W)	Power Factor (P.F.)	Energy Class	Product Size B*E*Y (mm)	Quantity in Box
NNFC4033154	PANASONIC LED SPLASH PROOF 36W 3960LM 1200MM 840	36	IP65	220-240	≥80	4000K	3960	110	0,9	E	1212*70.5*50.6	20
NNFC4038154	PANASONIC LED SPLASH PROOF 36W 3960LM 1200MM 865	36	IP65	220-240	≥80	6500K	3960	110	0,9	E	1212*70.5*50.6	20
NNFC4033254	PANASONIC LED SPLASH PROOF 45W 5000LM 1500MM 840	45	IP65	220-240	≥80	4000K	5000	111	0,9	E	1500*70.5*50.6	20
NNFC4038254	PANASONIC LED SPLASH PROOF 45W 5000LM 1500MM 865	45	IP65	220-240	≥80	6500K	5000	111	0,9	E	1500*70.5*50.6	20

## LED SPLASH PROOF SENSOR



4000K/6500K

0.9

25.000 Hour

Sensor-Fitted

Energy Class

CRI

Class

The luminaire will light up if it detects any human or object movement. Induction range max to 6.5m.

The luminaire will enter a 60s delay if it does not detects any human or object movement after the leaving of the persons, while keep lighting. After the 60s delay, The luminaire will automatically turn off.

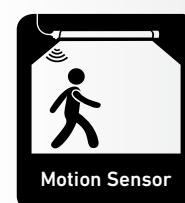

### Product Features:

- Motion detecting Radar Sensor
- Detection area with 3 m high installation and a diameter of 6,5 m
- Closing 60 seconds later when no motion is detected
- 2 different lumen and length options
- 4000K/6500K color temperatures

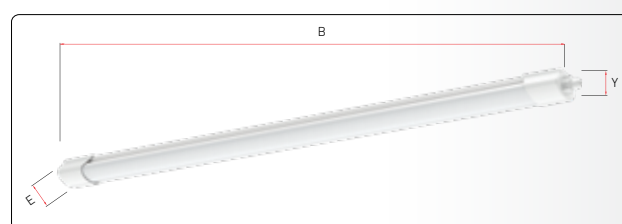
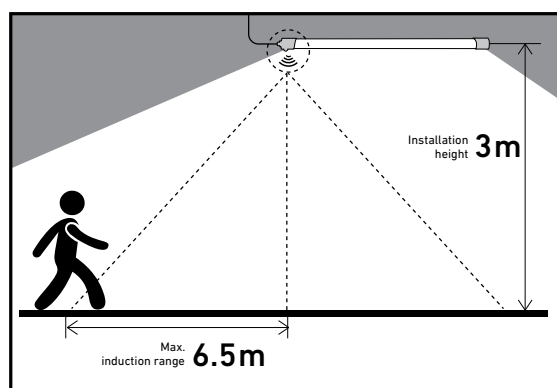

Product Code	Product Description	Power (W)	IP	Operating Voltage (V)	Color Rendering Index (Ra)	Color Temperature	Luminous Flux (lm)	Efficiency Factor (lm/W)	Power Factor (P.F.)	Energy Class	Product Size B*E*Y (mm)	Quantity in Box
NFV30501WE1E	PANASONIC LED SPLASH PROOF SENSOR 36W 3960LM 1200MM 840	36	IP65	220-240	≥80	4000K	3960	152	0,9	E	1212*71*51	20
NFV30503WE1E	PANASONIC LED SPLASH PROOF SENSOR 36W 3960LM 1200MM 865	36	IP65	220-240	≥80	6500K	3960	152	0,9	E	1212*71*51	20
NFV30504WE1E	PANASONIC LED SPLASH PROOF SENSOR 45W 5000LM 1500MM 840	45	IP65	220-240	≥80	4000K	5000	111	0,9	E	1500*71*51	20
NFV30506WE1E	PANASONIC LED SPLASH PROOF SENSOR 45W 5000LM 1500MM 865	45	IP65	220-240	≥80	6500K	5000	111	0,9	E	1500*71*51	20

## Panasonic LED Flood Light Panasonic LED Flood Light Sensor

*Quality, security, design...*

Panasonic offers durable and high quality lighting solutions for outdoor projects such as hotel car parks, gardens, etc. with a wide range of attractive LED Flood Light products from 10 to 200 Watt. Panasonic LED Flood Light with Sensor offers a universal and compact lighting with high lumen output levels and outstanding efficiency. They meet the expectations of safety as well as energy efficiency thanks to their motion and daylight-sensitive sensors.









## LED FLOODLIGHT



3000K/4000K/6500K

0.5/0.9

30.000 Hour

**F**

**80+**

**IK 05**

**CLASS II**

Energy Class

CRI

Impact Protection

Class

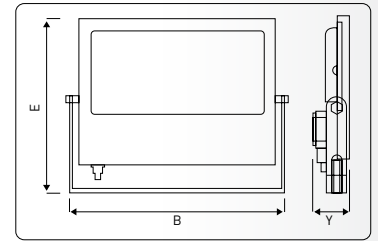

Product Code	Product Description	Power (W)	IP	Operating Voltage (V)	Color Rendering Index (Ra)	Color Temperature	Luminous Flux (lm)	Efficiency Factor (lm/W)	Power Factor (P.F.)	Energy Class	Product Size B*E*Y (mm)	Quantity in Box
NYV00021BE1E	PANASONIC LED FLOODLIGHT 10W 820LM 3000K	10	IP65	220-240	≥80	3000K	820	82	0,5	F	91*90*27	30
NYV00031BE1E	PANASONIC LED FLOODLIGHT 10W 850LM 4000K	10	IP65	220-240	≥80	4000K	850	85	0,5	F	91*90*27	30
NYV00071BE1E	PANASONIC LED FLOODLIGHT 10W 900LM 6500K	10	IP65	220-240	≥80	6500K	900	90	0,5	F	91*90*27	30
NYV00022BE1E	PANASONIC LED FLOODLIGHT 20W 1510LM 3000K	20	IP65	220-240	≥80	3000K	1.510	76	0,5	F	101*97*27	30
NYV00032BE1E	PANASONIC LED FLOODLIGHT 20W 1590LM 4000K	20	IP65	220-240	≥80	4000K	1.590	80	0,5	F	101*97*27	30
NYV00072BE1E	PANASONIC LED FLOODLIGHT 20W 1660LM 6500K	20	IP65	220-240	≥80	6500K	1.660	83	0,5	F	101*97*27	30
NYV00003BE1E	PANASONIC LED FLOODLIGHT 30W 2450LM 3000K	30	IP65	220-240	≥80	3000K	2.450	82	0,9	F	133*124*29	30
NYV00013BE1E	PANASONIC LED FLOODLIGHT 30W 2560LM 4000K	30	IP65	220-240	≥80	4000K	2.560	85	0,9	F	133*124*29	30
NYV00053BE1E	PANASONIC LED FLOODLIGHT 30W 2560LM 6500K	30	IP65	220-240	≥80	6500K	2.560	85	0,9	F	133*124*29	30
NYV00004BE1E	PANASONIC LED FLOODLIGHT 50W 4270LM 3000K	50	IP65	220-240	≥80	3000K	4.270	85	0,9	F	177*146*28	10
NYV00014BE1E	PANASONIC LED FLOODLIGHT 50W 4500LM 4000K	50	IP65	220-240	≥80	4000K	4.500	90	0,9	F	177*146*28	10
NYV00054BE1E	PANASONIC LED FLOODLIGHT 50W 4500LM 6500K	50	IP65	220-240	≥80	6500K	4.500	90	0,9	F	177*146*28	10
NYV00005BE1E	PANASONIC LED FLOODLIGHT 70W 5850LM 3000K	70	IP65	220-240	≥80	3000K	5.850	84	0,9	F	218*173*34	10
NYV00015BE1E	PANASONIC LED FLOODLIGHT 70W 5890LM 4000K	70	IP65	220-240	≥80	4000K	5.980	85	0,9	F	218*173*34	10
NYV00055BE1E	PANASONIC LED FLOODLIGHT 70W 6300LM 6500K	70	IP65	220-240	≥80	6500K	6.300	90	0,9	F	218*173*34	10
NYV00006BE1E	PANASONIC LED FLOODLIGHT 100W 8550LM 3000K	100	IP65	220-240	≥80	3000K	8.550	86	0,9	F	259*220*35	10
NYV00016BE1E	PANASONIC LED FLOODLIGHT 100W 9000LM 4000K	100	IP65	220-240	≥80	4000K	9.000	90	0,9	F	259*220*35	10
NYV00056BE1E	PANASONIC LED FLOODLIGHT 100W 9000LM 6500K	100	IP65	220-240	≥80	6500K	9.000	90	0,9	F	259*220*35	10
NYV00007BE1E	PANASONIC LED FLOODLIGHT 150W 12820LM 3000K	150	IP65	220-240	≥80	3000K	12.820	85	0,9	F	289*262*36	5
NYV00017BE1E	PANASONIC LED FLOODLIGHT 150W 13500LM 4000K	150	IP65	220-240	≥80	4000K	13.500	90	0,9	F	289*262*36	5
NYV00057BE1E	PANASONIC LED FLOODLIGHT 150W 13500LM 6500K	150	IP65	220-240	≥80	6500K	13.500	90	0,9	F	289*262*36	5
NYV00008BE1E	PANASONIC LED FLOODLIGHT 200W 17100LM 3000K	200	IP65	220-240	≥80	3000K	17.100	86	0,9	F	341*310*36	5
NYV00018BE1E	PANASONIC LED FLOODLIGHT 200W 18000LM 4000K	200	IP65	220-240	≥80	4000K	18.000	90	0,9	F	341*310*36	5
NYV00058BE1E	PANASONIC LED FLOODLIGHT 200W 18000LM 6500K	200	IP65	220-240	≥80	6500K	18.000	90	0,9	F	341*310*36	5

# LED FLOODLIGHT SENSOR



3000K/4000K/6500K



0.5/0.9



30.000 Hour



Sensor-Fitted



Energy Class



CRI



Impact Protection



Class

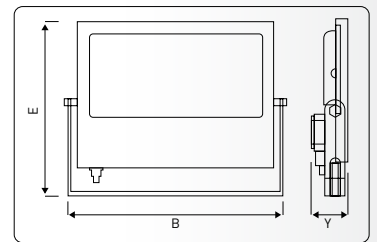

Product Code	Product Description	Power (W)	IP	Operating Voltage (V)	Color Rendering Index (Ra)	Color Temperature	Luminous Flux (lm)	Efficiency Factor (lm/W)	Power Factor (P.F.)	Energy Class	Product Size B*E*Y (mm)	Quantity in Box
NYV00201BE1E	PANASONIC LED FLOODLIGHT SENSOR 10W 820LM 3000K	10	IP65	220-240	≥80	3000K	820	82	0,5	F	101*97*27	30
NYV00211BE1E	PANASONIC LED FLOODLIGHT SENSOR 10W 850LM 4000K	10	IP65	220-240	≥80	4000K	850	85	0,5	F	101*97*27	30
NYV00251BE1E	PANASONIC LED FLOODLIGHT SENSOR 10W 900LM 6500K	10	IP65	220-240	≥80	6500K	900	90	0,5	F	101*97*27	30
NYV00202BE1E	PANASONIC LED FLOODLIGHT SENSOR 20W 1510LM 3000K	20	IP65	220-240	≥80	3000K	1510	76	0,5	F	133*124*29	30
NYV00212BE1E	PANASONIC LED FLOODLIGHT SENSOR 20W 1590LM 4000K	20	IP65	220-240	≥80	4000K	1590	80	0,5	F	133*124*29	30
NYV00252BE1E	PANASONIC LED FLOODLIGHT SENSOR 20W 1660LM 6500K	20	IP65	220-240	≥80	6500K	1660	83	0,5	F	133*124*29	30
NYV00203BE1E	PANASONIC LED FLOODLIGHT SENSOR 30W 2450LM 3000K	30	IP65	220-240	≥80	3000K	2450	82	0,9	F	177*146*28	30
NYV00213BE1E	PANASONIC LED FLOODLIGHT SENSOR 30W 2560LM 4000K	30	IP65	220-240	≥80	4000K	2560	85	0,9	F	177*146*28	30
NYV00253BE1E	PANASONIC LED FLOODLIGHT SENSOR 30W 2560LM 6500K	30	IP65	220-240	≥80	6500K	2560	85	0,9	F	177*146*28	30
NYV00204BE1E	PANASONIC LED FLOODLIGHT SENSOR 50W 4270LM 3000K	50	IP65	220-240	≥80	3000K	4270	85	0,9	F	177*146*28	10
NYV00214BE1E	PANASONIC LED FLOODLIGHT SENSOR 50W 4270LM 4000K	50	IP65	220-240	≥80	4000K	4270	85	0,9	F	177*146*28	10
NYV00254BE1E	PANASONIC LED FLOODLIGHT SENSOR 50W 4270LM 6500K	50	IP65	220-240	≥80	6500K	4270	85	0,9	F	177*146*28	10

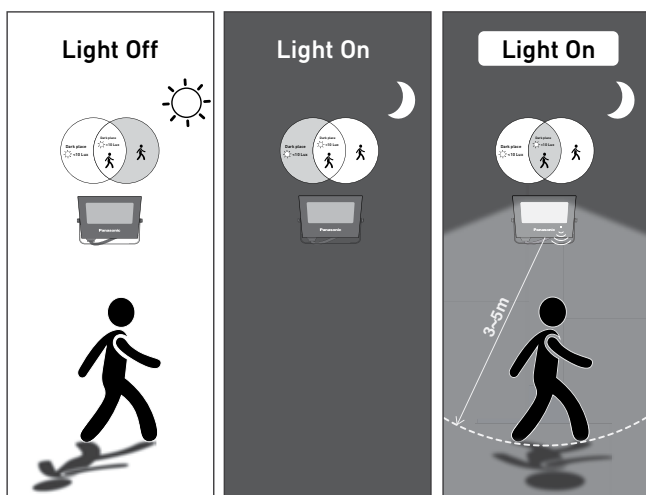

Trigger on once detect any movement at a angle of 120° and distance of 5m, and turn off automatically after 30s without the motion.



**Panasonic**

## **Panasonic LED Downlight**

*Easy installation, high efficiency, long lasting,  
in professional areas and residential/dwelling.*





## LED DOWNLIGHT



3000K/4000K/6500K



0.5/0.9



15,000 Hour



CRI



Class

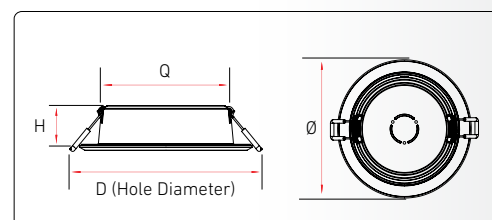

Product Code	Product Description	Power (W)	Input Voltage (V)	Ra	CCT	Lumen (lm)	Product Size D*Q*H (mm)	Quantity in Box
NNV70830WE1E	PANASONIC SDN LUMINAIRE 6W 450LM 830 Ø90	6	220-240	≥80	3000K	450	D109*Ø90*32	40
NNV70840WE1E	PANASONIC SDN LUMINAIRE 6W 480LM 840 Ø90	6	220-240	≥80	4000K	480	D109*Ø90*32	40
NNV70860WE1E	PANASONIC SDN LUMINAIRE 6W 480LM 865 Ø90	6	220-240	≥80	6500K	480	D109*Ø90*32	40
NNV70831WE1E	PANASONIC SDN LUMINAIRE 8W 600LM 830 Ø90	8	220-240	≥80	3000K	600	D109*Ø90*32	40
NNV70841WE1E	PANASONIC SDN LUMINAIRE 8W 640LM 840 Ø90	8	220-240	≥80	4000K	640	D109*Ø90*32	40
NNV70861WE1E	PANASONIC SDN LUMINAIRE 8W 640LM 865 Ø90	8	220-240	≥80	6500K	640	D109*Ø90*32	40
NNV70832WE1E	PANASONIC SDN LUMINAIRE 12W 900LM 830 Ø110	12	220-240	≥80	3000K	900	D129*Ø110*32	40
NNV70842WE1E	PANASONIC SDN LUMINAIRE 12W 960LM 840 Ø110	12	220-240	≥80	4000K	960	D129*Ø110*32	40
NNV70862WE1E	PANASONIC SDN LUMINAIRE 12W 960LM 865 Ø110	12	220-240	≥80	6500K	960	D129*Ø110*32	40
NNV70833WE1E	PANASONIC SDN LUMINAIRE 15W 1125LM 830 Ø125	15	220-240	≥80	3000K	1.125	D144*Ø125*32	30
NNV70843WE1E	PANASONIC SDN LUMINAIRE 15W 1200LM 840 Ø125	15	220-240	≥80	4000K	1.200	D144*Ø125*32	30
NNV70863WE1E	PANASONIC SDN LUMINAIRE 15W 1200LM 865 Ø125	15	220-240	≥80	6500K	1.200	D144*Ø125*32	30
NNV70834WE1E	PANASONIC SDN LUMINAIRE 18W 1350LM 830 Ø150	18	220-240	≥80	3000K	1.350	D169*Ø150*32	30
NNV70844WE1E	PANASONIC SDN LUMINAIRE 18W 1440LM 840 Ø150	18	220-240	≥80	4000K	1.440	D169*Ø150*32	30
NNV70864WE1E	PANASONIC SDN LUMINAIRE 18W 1440LM 865 Ø150	18	220-240	≥80	6500K	1.440	D169*Ø150*32	30
NNV70835WE1E	PANASONIC SDN LUMINAIRE 24W 1800LM 830 Ø175	24	220-240	≥80	3000K	1.800	D194*Ø175*32	30
NNV70845WE1E	PANASONIC SDN LUMINAIRE 24W 1920LM 840 Ø175	24	220-240	≥80	4000K	1.920	D194*Ø175*32	30
NNV70865WE1E	PANASONIC SDN LUMINAIRE 24W 1920LM 865 Ø175	24	220-240	≥80	6500K	1.920	Ø194*Ø175*32	30

## Accessories

Product No	Description	Corresponding Prpduct Size (mm)	Product Size (mm)	Net Weight (g)	Individual Box Gross Weight (g)	Outer Carton Qty (pcs)	Corresponding Downlight
NNV9000WM1E	Surface Mounting Frame for DL	Cut-out Ø90 6W Cut-out Ø90 9W	Ø109*H45	62	93	20	NNV70830WE1E, NNV70840WE1E, NNV70860WE1E NNV70831WE1E, NNV70841WE1E, NNV70861WE1E
NNV90001WM1E	Surface Mounting Frame for DL	Cut-out Ø110 9W Cut-out Ø110 12W	Ø114*H45	74	117	20	NNV70832WE1E, NNV70842WE1E, NNV70862WE1E
NNV90002WM1E	Surface Mounting Frame for DL	Cut-out Ø125 12W Cut-out Ø125 15W	Ø144*H45	77	123	20	NNV70833WE1E, NNV70843WE1E, NNV70863WE1E
NNV90003WM1E	Surface Mounting Frame for DL	Cut-out Ø150 15W Cut-out Ø150 18W	Ø170*H45	91	144	20	NNV70834WE1E, NNV70844WE1E, NNV70864WE1E
NNV90004WM1E	Surface Mounting Frame for DL	Cut-out Ø175 18W Cut-out Ø175 24W	Ø194*H45	107	180	20	NNV70835WE1E, NNV70845WE1E, NNV70865WE1E

**Panasonic**







**We have been working for a more liveable life  
for more than 100 years.**



Panasonic Electric Works Elektrik San. ve Tic. A.Ş.

Abdurrahmangazi Mah. Ebubekir Cad. No: 44 34887 Sancaktepe İstanbul / Türkiye  
T: +90 (216) 564 55 55 F: +90 (216) 564 55 44 ewtr.panasonic.com info@tr.panasonic.com

**Panasonic**